

This user guide contains essential information in relation to safe use and maintenance and should be retained with the shower stretcher for reference

ShowerStretcher



User Guide

TRT11 Flat bed stretcher

TRT12 Adjustable backrest stretcher

TRT13 Padded liner stretcher

ShowerStretcher

Contents

Safety Considerations	1
Installation Instruction.....	2
User Instruction	3
Latch Operation & Adjustment.....	4
Cleaning & Maintenance	5
Spare Parts.....	6
Dimensions.....	7
Warranty	8

These products have been designed to the highest standards with safety, strength and quality in mind.

Follow the recommendations in this guide to ensure maximum benefit from your shower stretcher.

Your Chiltern Invadex shower stretcher has been designed and tested to meet the highest standards of safety. Read the safety section of this guide prior to use, this is contained on page 1.

Safety Considerations



This section should be read and understood prior to use of the shower stretcher. Failure to adhere to the below can lead to serious injury. Should clarification of any point be required, please call Chiltern Invadex on 01869 365500 prior to use.

- Ensure that installation instructions are read and understood prior to commencing installation. Should additional information be required please contact the technical department on 01869 365500.
- Fixings provided assume a sound solid wall, ultimately fixings must be assessed on site by the installer based on the supporting wall fabric. If in doubt this must be confirmed with a fixings supplier.
- This guide should be thoroughly read and understood by all users. It should be retained for future reference.
- Maximum user weight must not be exceeded;

TRT11 & TRT12	130kg (20 stone)
TRT13	190kg (30 stone)
- The TRT13 shower stretcher is a showering aid and is not intended for use as a bath, the stretcher must not be filled with water.
- Prior to each use of the TRT13, inspect the cot side and brackets for signs of distortion or damage. The stretcher must not be used if any damage is observed.
- Under no circumstances should a client be left alone in the shower stretcher.
- Where the trolley is to be used by multiple bathers, cleaning with a medical disinfectant to prevent cross contamination is strongly recommended. (follow the maintenance schedule on page 5).
- The lift/transfer of the client should be assessed and planned by a trained person.
- It is recommended that shower stretchers are inspected by a qualified engineer at least annually, six monthly in areas of high use (eg institutional use).



Where there is any doubt as to the safety of the stretcher it should be removed from use pending inspection by a competent person.

Installation Instruction

Appropriate PPE should be worn when installing the stretcher.

1. Unfold the legs and secure the pins as fig 1.
2. Position the unit against the wall and level along its length and width using a spirit level. The height of the legs can be adjusted (prior to fitting) by removing the rubber ferrules, cutting the legs to the desired length using a hacksaw and replacing the ferrules.
Note 1: The TRT13 model must be fitted with the drain end 40mm lower than the head end to facilitate drainage.
3. Mark the position of the four fixing holes and remove the unit. Refer to page 7 for dimensions.
Note 2: When marking the fixing positions the rubber ferrules must sit securely on the floor.
4. Drill the wall using a Nr 14 drill. Fix the unit to the wall using the Nr 14 plugs and M10x70 coach screws provided (see fig 2)

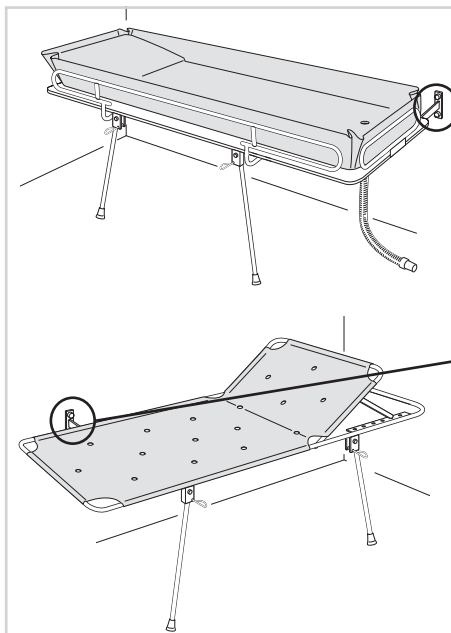
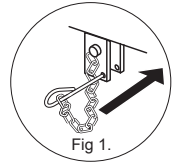
Safety first: The stretcher is only as strong as the wall and fixings. It is the responsibility of the installer to ensure that the wall is strong enough to take the load and that the supplied fixings are sufficient. If in doubt check with your local fixings supplier.
5. Ensure that the fixing is secure and fit the plastic screw covers.
6. Check that the stretcher is level (refer to note 1) and ensure that the legs are securely positioned on the floor with the pins and chains located as fig 1.



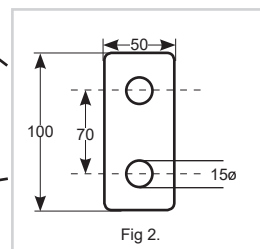

7. Release the legs and secure. Fold the stretcher up against the wall, mark the wall catch position and install.
8. Check that the wall catch is secure.

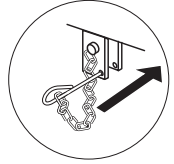

User Instruction



1. Unfold the stretcher legs from their holding clips and secure in place using the pins and chains.
2. Grip the top of the stretcher and pull from the wall catch positioning the legs firmly on the floor. If the legs do not sit securely on the floor the stretcher must not be used.
3. Prior to use, inspect the stretcher for signs of distortion on the side rails (where fitted) and latches. If the item is damaged it should be considered unsafe. The stretcher must not be used if any signs of damage are observed.
4. The TRT13 stretcher should be fitted at a slight angle to allow water to run off through the outlet pipe. To ensure that water does not congregate around the users head, check that the liner is inserted correctly. (i.e that the outlet pipe is located at the lower end of the stretcher.)
5. Adjustable backrest (TRT12) The backrest should be adjusted prior to any transfer or where the client is physically unable to sit whilst the amendments are made. Lift the backrest to the desired height and locate both sides of the frame securely into the required slot.
 **Note:** Ensure that the backrest is set to the same position on both sides of the frame and test to ensure it is secure.
6. Where cot sides are in use - pull the latch lever down to release the cot side. Unclip the poppers on the corners of the liner and lay the liner flat.
7. Position the bather into the shower stretcher.
 **Note:** Prior to attempting any transfer the action should be planned and prepared.
8. Where cot sides are in use - refix the shower liner corners and reposition the cot side.
 **Note:** Ensure that the latch locks securely into place (see page 4)
9. Proceed with bathing.
10. When bathing is complete remove the bather by repeating operations 1-7 in reverse.
11. Where the stretcher is to be used by multiple bathers it is strongly recommended that the stretcher is cleaned after each use using a medical disinfectant.



Never leave a user unattended in a shower stretcher



Latch Operation & Adjustment

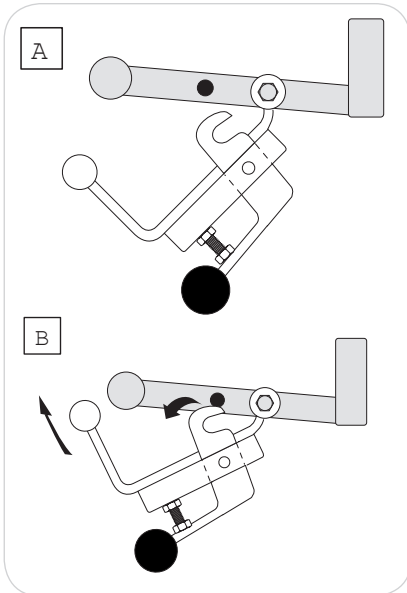

1.

As the side rail of the stretcher is lifted, the latch makes contact with the locating pin. As you continue to lift the latch opens and finally clicks over the pin. As shown in A & B.

There should be no reason to open the latch manually to achieve closure.

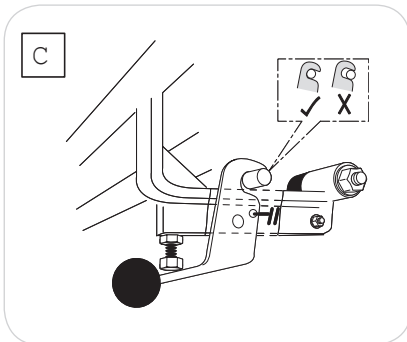

2.

When the side rail is vertical, the latch should be fully engaged as shown in C.

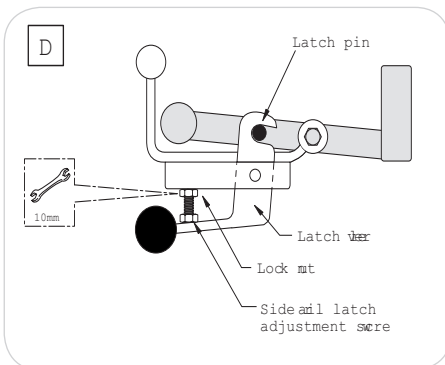

3.

If the latch is only partially engaged, the adjusting screw is too far out.

If the latch does not open automatically the screw needs adjusting outwards. A small amount of silicone grease on the top of the latch will assist with the automatic action. When any adjustment is made the lock nut must be fully tightened. See figure D.

Cleaning & Maintenance

Prior to Use

Check cot sides and latches (where fitted) are secure and undamaged.

After Use

Rinse the unit, particularly the bathing area with warm clean water. Use a non abrasive cleaner if soiled. For institutional use where the device is to be used by multiple bathers it is strongly recommended that a medical disinfectant is used. Contact your infection control officer for details of disinfectants approved for this use by your institution.

Weekly

Thoroughly clean the unit, particularly the bathing area with warm clean water and a non abrasive cleaner. For institutional use where the device is to be used by multiple bathers it is strongly recommended that a medical disinfectant is used. Contact your infection control officer for details of disinfectants approved for this use by your institution.

Monthly (TRT13 only)

Flush the waste pipe with a disinfectant to help avoid cross contamination.

Yearly

It is recommended that the stretcher is inspected at least annually by a qualified engineer.

Re-issue

Where a stretcher is owned by a loan store or other authority where it is likely to be re-issued. It is recommended that the item is fully disinfected and subjected to a full inspection prior to re-issue.

It is recommended that wall fixings are replaced.

Spare Parts

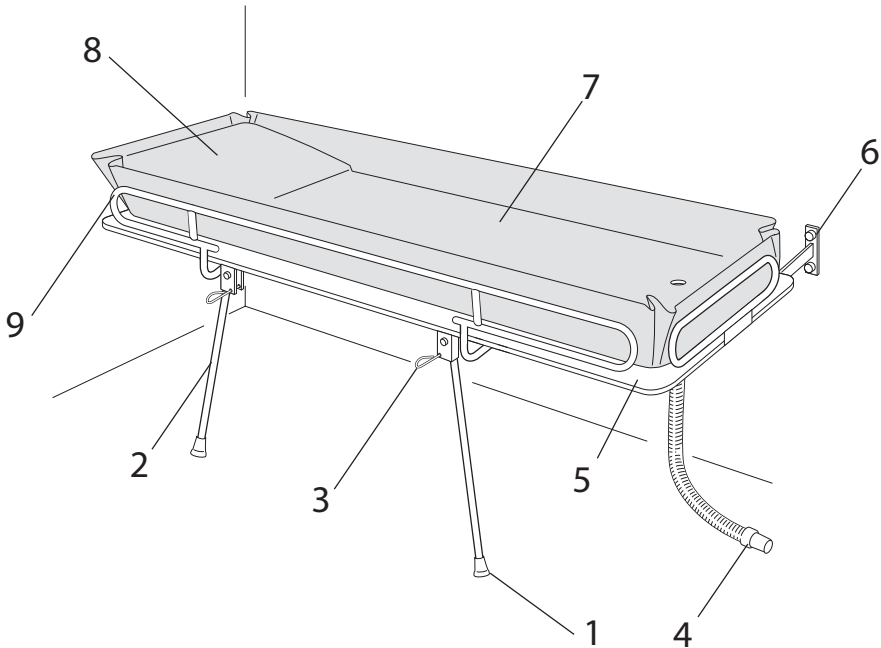

Item	Description	Part number	Model
1	Rubber ferrule	CH001	All
2	Stretcher leg	TRA1101	All
3	Chain and pin	TRTS037	All
4	Waste hose	TRTS010	TRT13
5	Stretcher plastic top	CH0174	TRT13
6a	Wall brackets & fixings	TRTS030	TRT11 & TRT12
6b	Wall brackets & fixings	TRTS031	TRT13
7	Stretcher liner**	TRTS001V	TRT13
8	Wedge cushion**	TRTS003	TRT13
9	*Cot side	TRTS038	TRT13
Not shown	Cot side latch assembly	TRA0117	TRT13

In the interests of user safety it is recommended that parts indicated * should be installed by a qualified engineer

**Part numbers supplied are for standard Grey fabric, if your fabric is any other colour please call.

If your stretcher has been custom made (ie the text SPEC is marked on the product label), please call.

TRT11 and TRT12 stretchers have non-replaceable HF welded vinyl tops.

Model Identification

TRT11

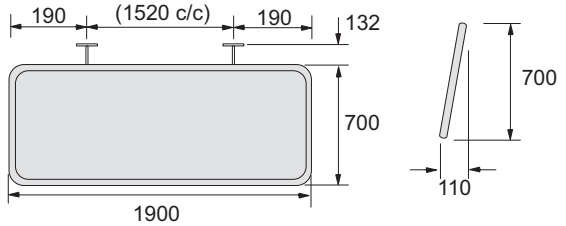
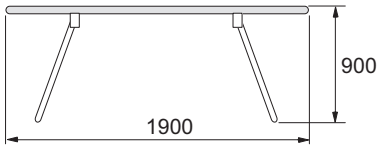

TRT12

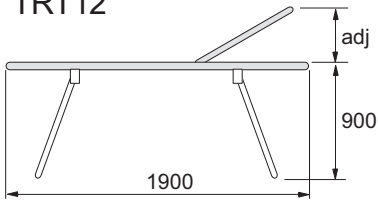

TRT13

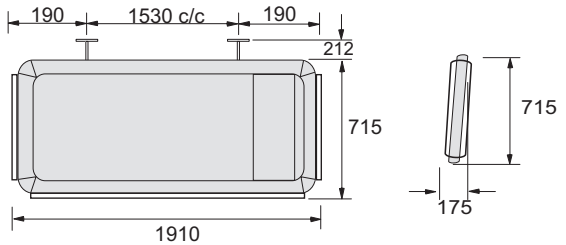
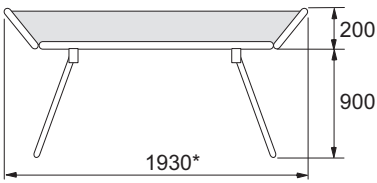

* Dimension to outside of cotsides

Stretchers outside of the above dimensions have been custom made, should assistance be required, please call customer services with the product serial number.

Warranty

Your Chiltern Invadex Shower Stretcher carries a 12 month warranty from the date of purchase, subject to the following conditions;

1. Should you experience any problems with our workmanship or materials within the first 12 month period please contact your point of purchase.
2. Repairs made during the warranty period will be carried out free of charge, provided the product has been used strictly in accordance with the guidelines set out in this user guide.
3. Our warranty does not cover replacements, adjustments or repairs which may be required as a result of normal wear and tear, wilful or accidental damage, misuse, neglect or any other cause which is beyond the control of Chiltern Invadex.
4. Modifications and repairs made to this product by unauthorised persons will render the warranty void.
5. Only parts manufactured or approved by Chiltern Invadex shall be used to repair this product. Use of unauthorised parts will invalidate all warranties and remove all liability from Chiltern Invadex for the safety of this product.
6. Chiltern Invadex shall in no event be liable for any damages, costs or expenses arising from any claim made under this warranty (save for any legal liability of Chiltern Invadex for death or personal injury resulting from the company's negligence in respect of its products).
7. This warranty does not affect your statutory consumer rights.

The below space can be used to store details of your maintenance contractor, if the equipment has been provided by a third party for example the Local Authority loan store, this information will be available from them.

Contractor name: _____

Contact number: _____

Account number: _____

Serial number: _____

ShowerStretcher



Chiltern Invadex (UK) Limited
Unit 6C
Thorpe Drive
Banbury
OX16 4UZ
UK



+44 (0)1869 365500



sales@chilterninvadex.co.uk



www.chilterninvadex.co.uk

To request a copy of this guide in large print
please contact
customer services on 01869 365500 opt 1 or
email: sales@chilterninvadex.co.uk



FM553189